

WR-19 Waveguide Power Divider, 2 Way, 44 to 60 GHz

Description:

Model SWP-40360302-19-S1X-WP is a U band, 2-way power divider that operates from 44 to 60 GHz. The power divider offers a typical insertion loss of 0.3 dB and typical isolation of 20 dB. All ports are well-balanced and in-phase for power dividing or combining applications across the band. The power divider is configured as a right-angle package with WR-19 waveguides and UG-383/U-M anti-cocking flanges at all ports. An inline, 2-way configuration is offered under model **SWP-40360302-19-E1-3**. Other power splitting options, such as 4-way, 8-way, and 16-way division, are available for both right-angle and inline configurations under different model numbers.



Features:

- Full band Performance
- Low Insertion Loss
- Excellent Port Balance
- High Isolation
- Instrumentation Grade

Applications:

- Test Labs
- Instrumentation
- Sub-assemblies

Electrical Specifications:

Parameter	Minimum	Typical	Maximum
Frequency	44 GHz		60 GHz
Insertion Loss		0.3 dB	
Isolation		20 dB	
Return Loss		17 dB	
Specification Temperature		+25 °C	
Operating Temperature	-40 °C		+85 °C

Mechanical Specifications:

Item	Specification
RF Ports	WR-19 Waveguide with UG-383/U-M Anti-Cocking Flange
Material	Brass
Finish	Gold Plated
Outline	WP-U2-A



WR-19 Waveguide Power Divider, 2 Way, 44 to 60 GHz

Measured Performance vs. Frequency

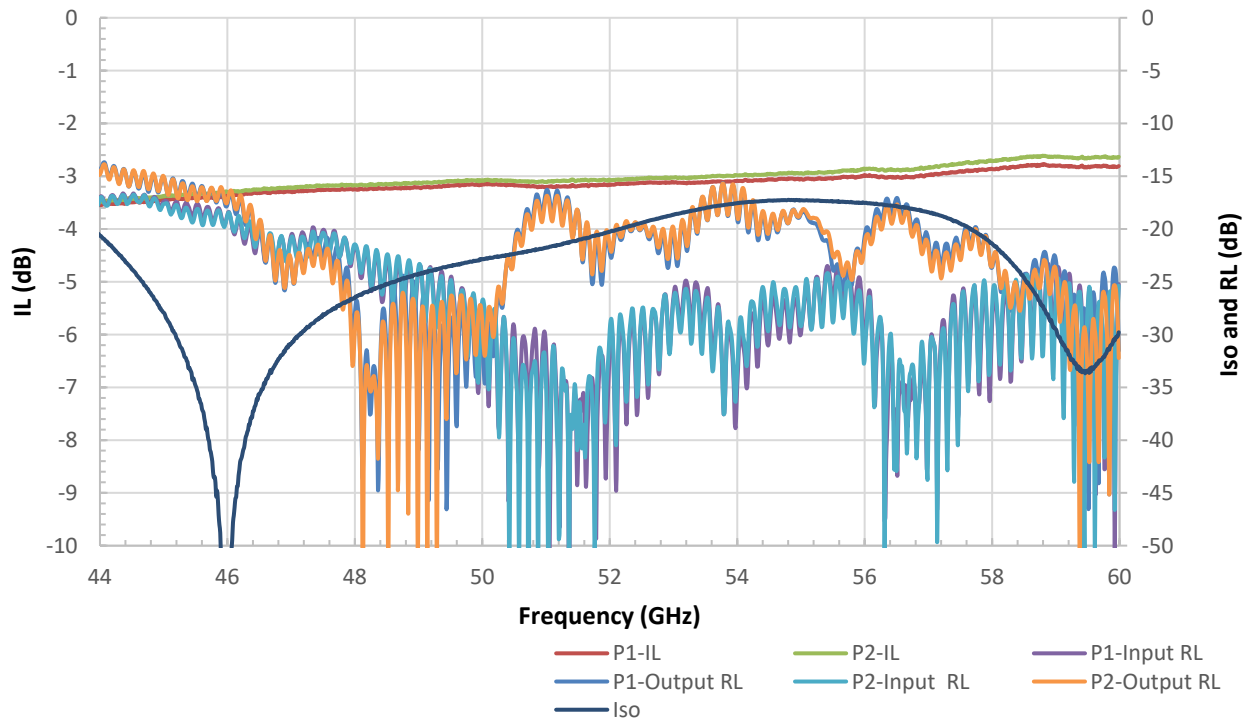

Mechanical Outline: (Unless otherwise specified, all dimensions are in inches [millimeters])

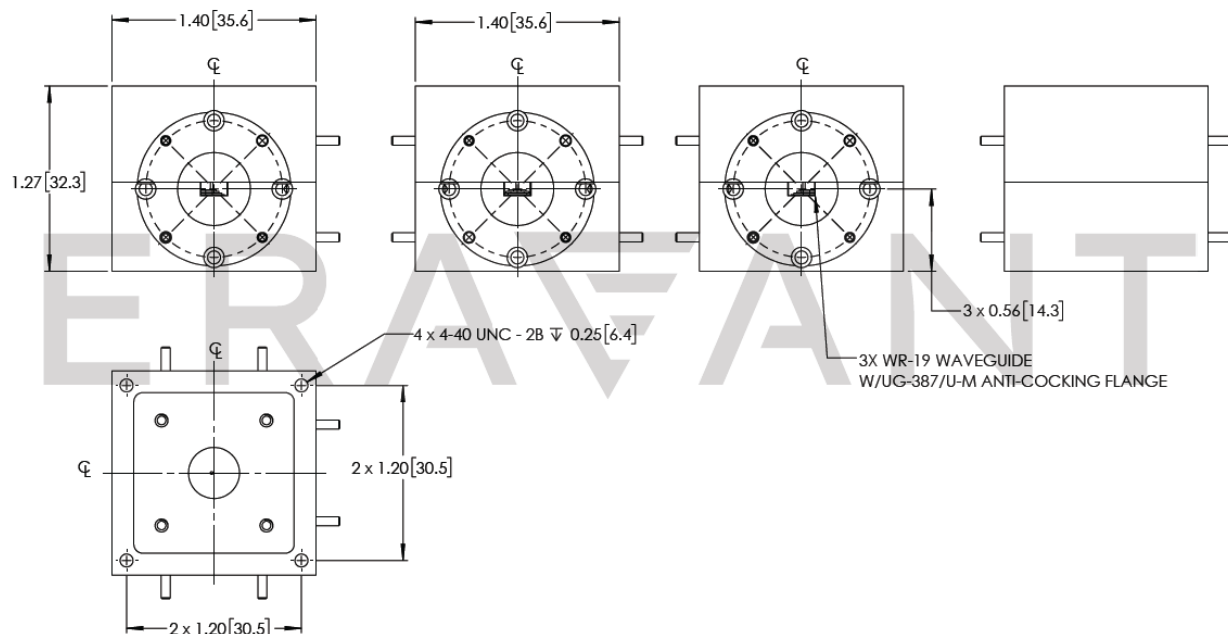

WR-19 Waveguide Power Divider, 2 Way, 44 to 60 GHz

Note:

- All data presented is collected from a sample lot. Actual data may vary unit to unit slightly.
- All testing was performed under +25 °C case temperature.
- Eravant reserves the right to change the information presented without notice.

Caution:

- Any foreign objects in the waveguide will degrade performance and/or damage the device.

