

Manual Waveguide Switch, V-Band, H-Plane

Description:

Model SWJ-15-M1-H is a V-band manual waveguide switch that covers the frequency range of 50 to 75 GHz. The switch is a H-plane type, bi-directional, multi-path device with a 3-channel rotor which allows for switching between four distinct positions. The typical insertion loss and isolation are 0.4 dB and 60 dB, respectively. The RF ports are WR-15 waveguides with UG-385/U anti-cocking flanges. The E-plane version of the switch is offered under model **SWJ-15-M1**.



Features:

- Low Insertion Loss
- High Isolation
- Clockwise or Anti-clockwise Rotation
- 3-Channel Rotor

Applications:

- Test Set
- Communication Systems
- Radar Systems

Electrical Specifications:

Parameter	Minimum	Typical	Maximum
Frequency	50 GHz		75 GHz
Insertion Loss		0.4 dB	
Isolation		60 dB	
Return Loss		23 dB	
Specification Temperature		+25 °C	
Operating Temperature	-40 °C		+85 °C

Mechanical Specifications:

Item	Specification
RF Ports	WR-15 Waveguide with UG-385/U Anti-Cocking Flange
Port Orientation	H-Plane
Material	Brass
Finish	Gold Plated
Outline	WJ-MV-A-H

Manual Waveguide Switch, V-Band, H-Plane

Mechanical Outline: (Unless otherwise specified, all dimensions are in inches [millimeters])

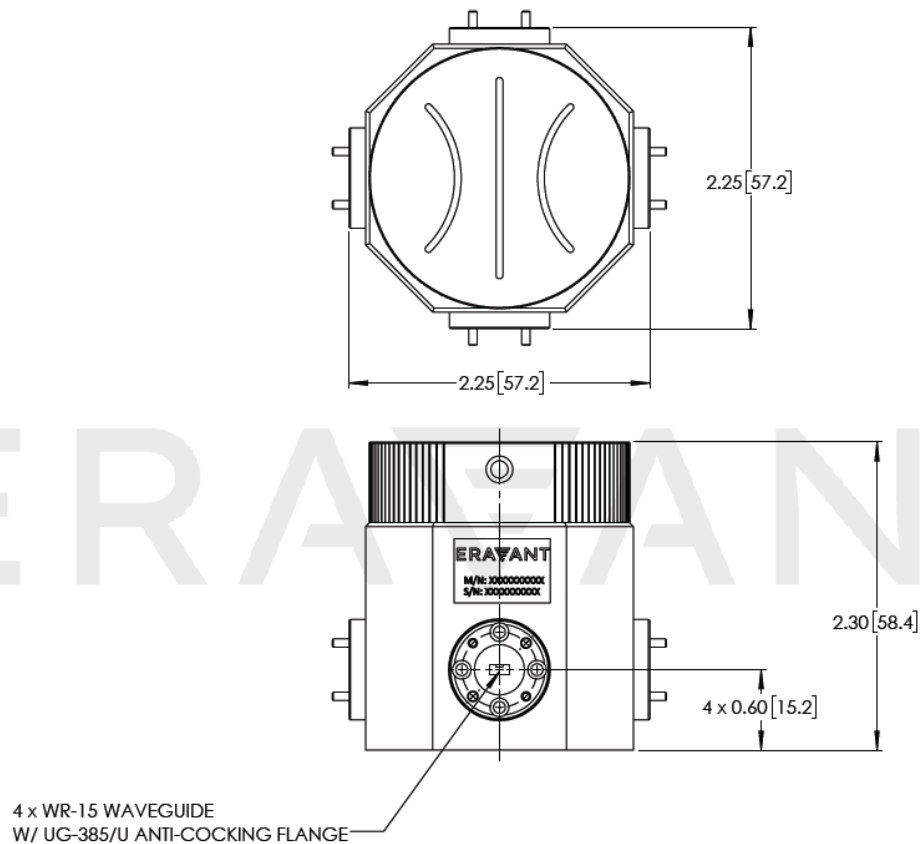

Note:

- Datasheet photo is a render and may not be representative of the final product.
- All electrical and mechanical specs are preliminary and may differ from the final design.
- Eravant reserves the right to change the information presented without notice.

Caution:

- Any foreign objects in the waveguide will cause performance degradation and possible device damage.