



Q-Band Waveguide to 2.92 mm Connector Adapter, Right Angle

Description:

Models **SWC-22KF-R1** and **SWC-22KM-R1** are right angle (90°) Q-band waveguide to coax adapters that cover the frequency range of 33 to 43 GHz. They are designed and manufactured for instrumentation grade quality but offered at a commercial grade price, allowing for an efficient transition between the rectangular waveguide and 2.92 mm (K) coax connector. The end launch (180°) versions are offered under model numbers SWC-22KF-E1 and SWC-22KM-E1.



Features:

- 33 to 43 GHz Coverage
- Lower Insertion Loss and Return Loss
- Instrumentation Grade
- DC Open Circuit

Applications:

- Test Lab
- Instrumentations
- Sub-assemblies

Electrical Specifications:

Parameter	Minimum	Typical	Maximum
Frequency Range	33 GHz		43 GHz*
Insertion Loss**		0.4 dB	0.7 dB
Return Loss	16 dB	18 dB	
Power Handling			50 W (CW)
Specification Temperature		+25 °C	
Operating Temperature	-40 °C		+85 °C

*Operating Frequency is limited by the 2.92 mm connector.

**Insertion loss is tested back to back with a male and female adapter, the result is divided by 2.

Mechanical Specifications:

Item	Parameter
Waveguide	WR-22 with UG-383/U Flange
Coaxial	2.92 mm (K) Female for Model Number: SWC-22KF-R1
Coaxial	2.92 mm (K) Male for Model Number: SWC-22KM-R1
Housing Material	Aluminum
Finish	Gold Plated
Weight	0.4 Oz
Size	1.00" (L) x 1.13" (Ø)
Outline	WC-QR





Q-Band Waveguide to 2.92 mm Connector Adapter, Right Angle

Typical Return Loss & Back to Back Insertion Loss vs. Frequency

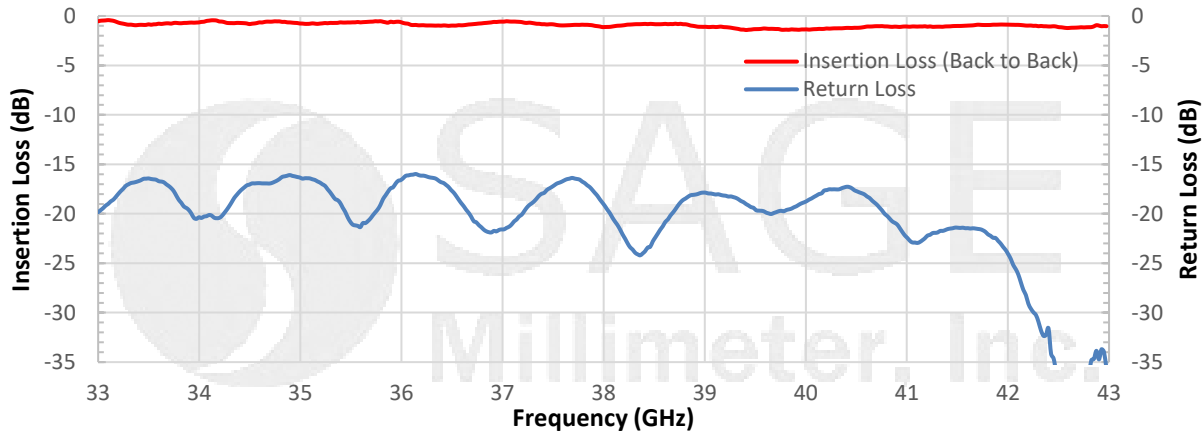

Mechanical Outline: (Unless otherwise specified, all dimensions are in inches [millimeters])

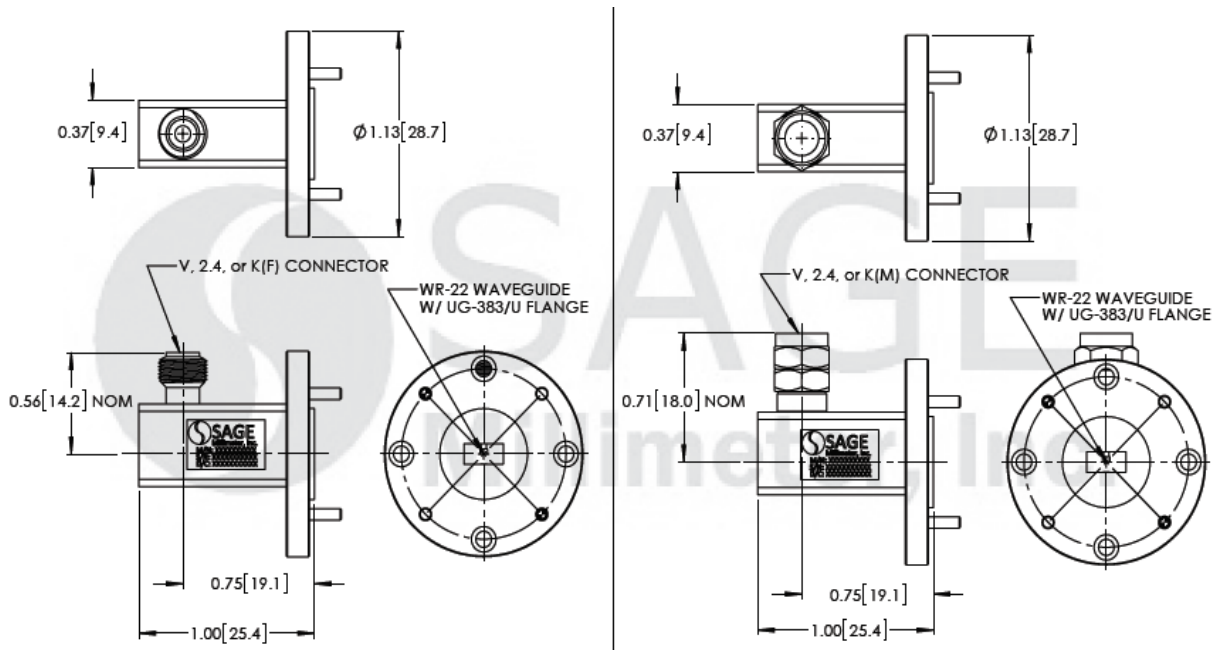

Note:

- All data presented is collected from a sample lot, actual data may vary unit to unit.
- All testing was performed under +25 °C case temperature.
- SAGE Millimeter, Inc. reserves the right to change the information presented without notice.

Caution:

- Any foreign objects in the waveguide will cause performance degradation and may damage the adapter.
- Proper torque, 8.0 ± 0.15 inch-pounds (0.90 ± 0.02 Nm), should be applied. **SAGE Millimeter torque wrench, model SCH-08008-S1, is highly recommended.**

