



WR-15 Waveguide to 1.85mm Connector Adapter, Right Angle

Description:

Model SWC-15VF-R1 is a right angle (90°) WR-15 waveguide to coax adapter that covers the frequency range of 50 to 70 GHz. They are designed and manufactured for instrumentation grade quality but offered at a commercial grade price, allowing for an efficient transition between the rectangular waveguide and 1.85 mm (V) coax connector. Eravant also offers the male connector right angle version (**SWC-15VM-R1**) and both male and female connector end launch (180°) versions (**SWC-15VF-E1**, **SWC-15VM-E1**).



Features:

- Broadband Coverage
- Low Insertion Loss and VSWR
- Instrumentation Grade
- DC Open Circuit

Applications:

- Test Lab
- Instrumentations
- Sub-assemblies

Electrical Specifications:

Parameter	Minimum	Typical	Maximum
Frequency Range	50 GHz		70 GHz*
Insertion Loss*		0.7 dB	1.0 dB
Return Loss	13 dB	16 dB	
Power Handling			40 W (CW)
Specification Temperature		+25 °C	
Operating Temperature	-40 °C		+85 °C

* The adapter can cover up to 75 GHz with slight performance degradation due to the frequency limitations of the 1.85 mm (V) coaxial connector.

*Insertion Loss is tested back-to-back with a male and female adapter; the result is divided by 2.

Mechanical Specifications:

Item	Parameter
Waveguide Port	WR-15 Waveguide with UG-385/U Flange
Coaxial Port	1.85 mm (V) Female Connector
Material	Aluminum
Finish	Gold Plated
Weight	0.30 oz
Outline	WC-VR





WR-15 Waveguide to 1.85mm Connector Adapter, Right Angle

Typical Performance vs Frequency

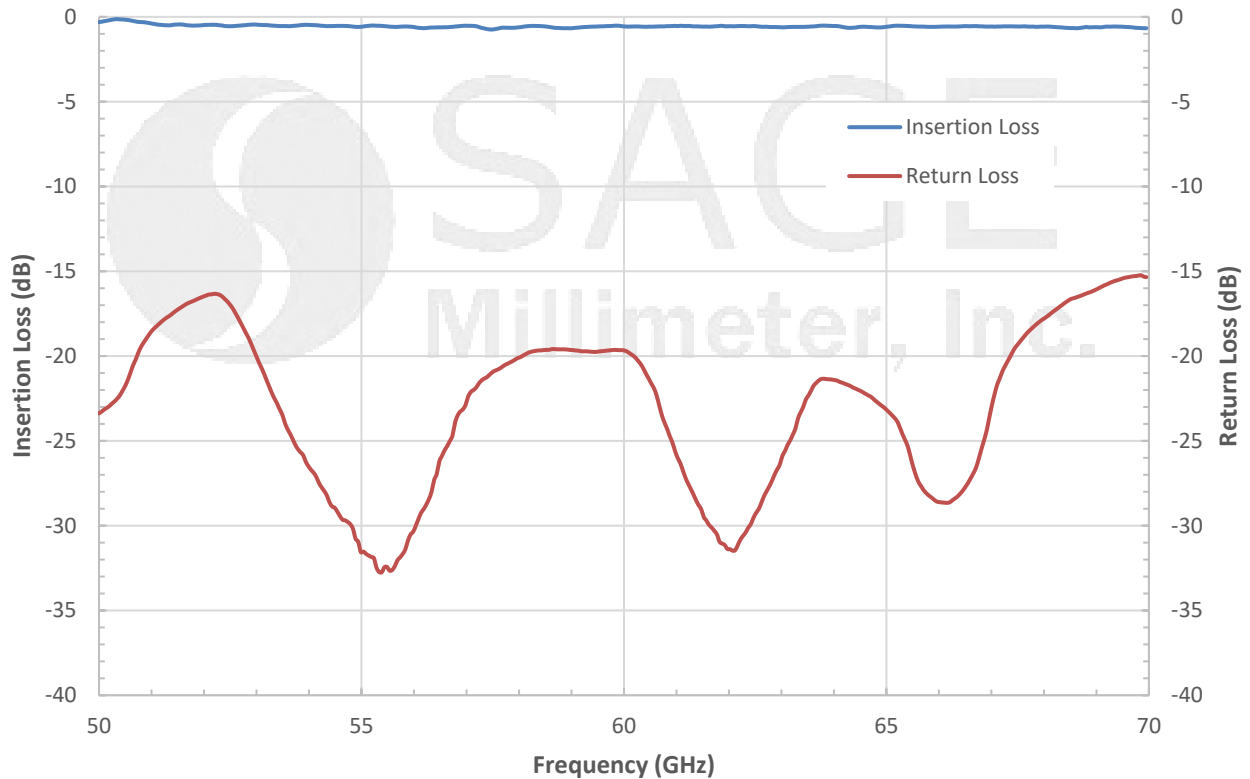

Mechanical Outline: (Unless otherwise specified, all dimensions are in inches [millimeters])

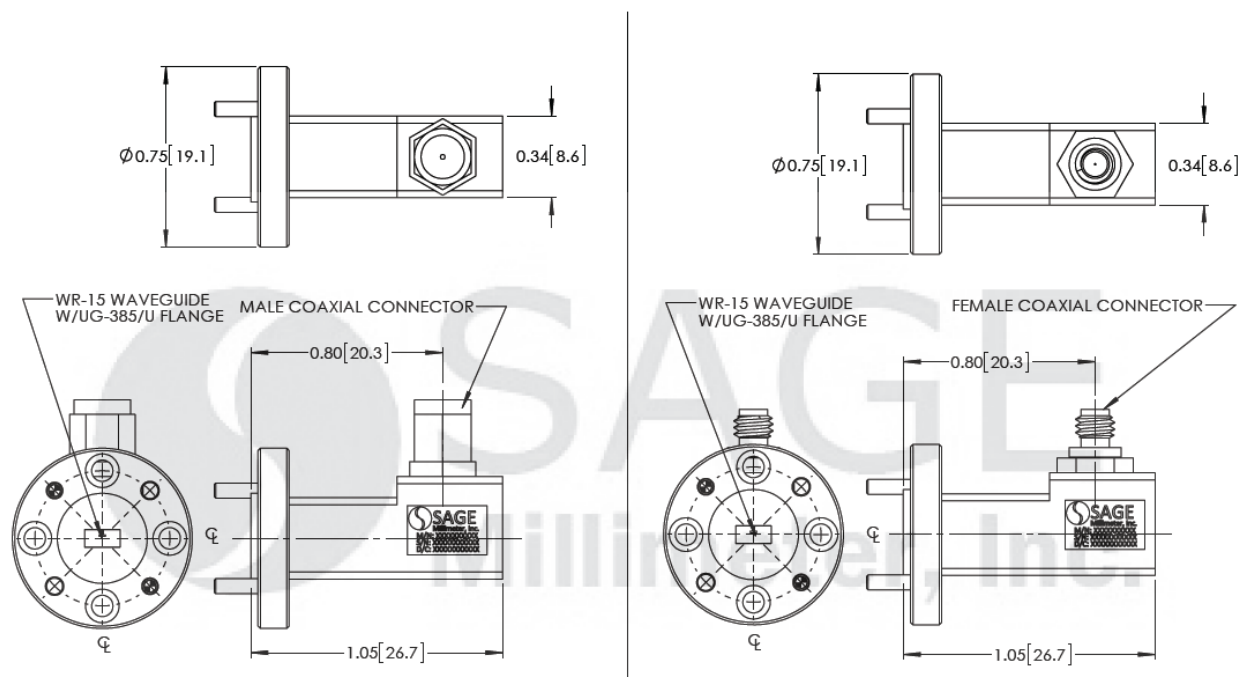

www.sagemillimeter.com | 3043 Kashiwa Street, Torrance, CA 90505
 Phone: 424-757-0168 | Fax: 424-757-0188 | Email: sales@sagemillimeter.com



WR-15 Waveguide to 1.85mm Connector Adapter, Right Angle

Note:

- All data presented is collected from a sample lot. Actual data may vary unit to unit, slightly.
- All testing was performed under +25 °C case temperature.
- SAGE Millimeter, Inc. reserves the right to change the information presented without notice.

Caution:

- Any foreign objects in the waveguide will cause performance degradation and may damage the adapter.
- Proper torque, 8.0 ± 0.15 inch-pounds (0.90 ± 0.02 Nm), should be applied. **SAGE Millimeter torque wrench (SCH-08008-S1) is highly recommended.**

