

WR-12 Compact Waveguide Twist, 90°, 0.40"

Description:

SWB-12090-TB-0.40-WP is a WR-12, 90°, compact waveguide twist with a UG-387/U-M flange on one end. The opposite end is compatible with a UG-387/U-M flange with 5/64 hex socket captive waveguide screws for attachment. The overall length of the twist is 0.40". The waveguide twist is manufactured through a precision machining process to ensure high quality and ruggedness. The waveguide twist is offered to cover the frequency range of 60 to 85 GHz.



Features:

- Frequency Coverage: 60 to 85 GHz
- Rugged Waveguide Configuration
- Low Insertion Loss
- Compact Size

Applications:

- Test Instrumentation
- Sub-assemblies
- Lab Use

Electrical Specifications:

Parameter	Minimum	Typical	Maximum
Frequency	60 GHz		85 GHz
Insertion Loss		0.2 dB	
Return Loss		20 dB	
Specification Temperature		+25 °C	
Operating Temperature	-40 °C		+85 °C

Mechanical Specifications:

Item	Specification
Waveguide Size	WR-12 Waveguide with UG-387/U-M Flange
Twist Angle	90 Degrees
Insertion Length	0.40"
Material	Brass
Finish	Gold Plated
Weight	0.6 Oz
Outline	WB-TE-0.40

WR-12 Compact Waveguide Twist, 90°, 0.40"

Typical Insertion and Return Loss vs. Frequency

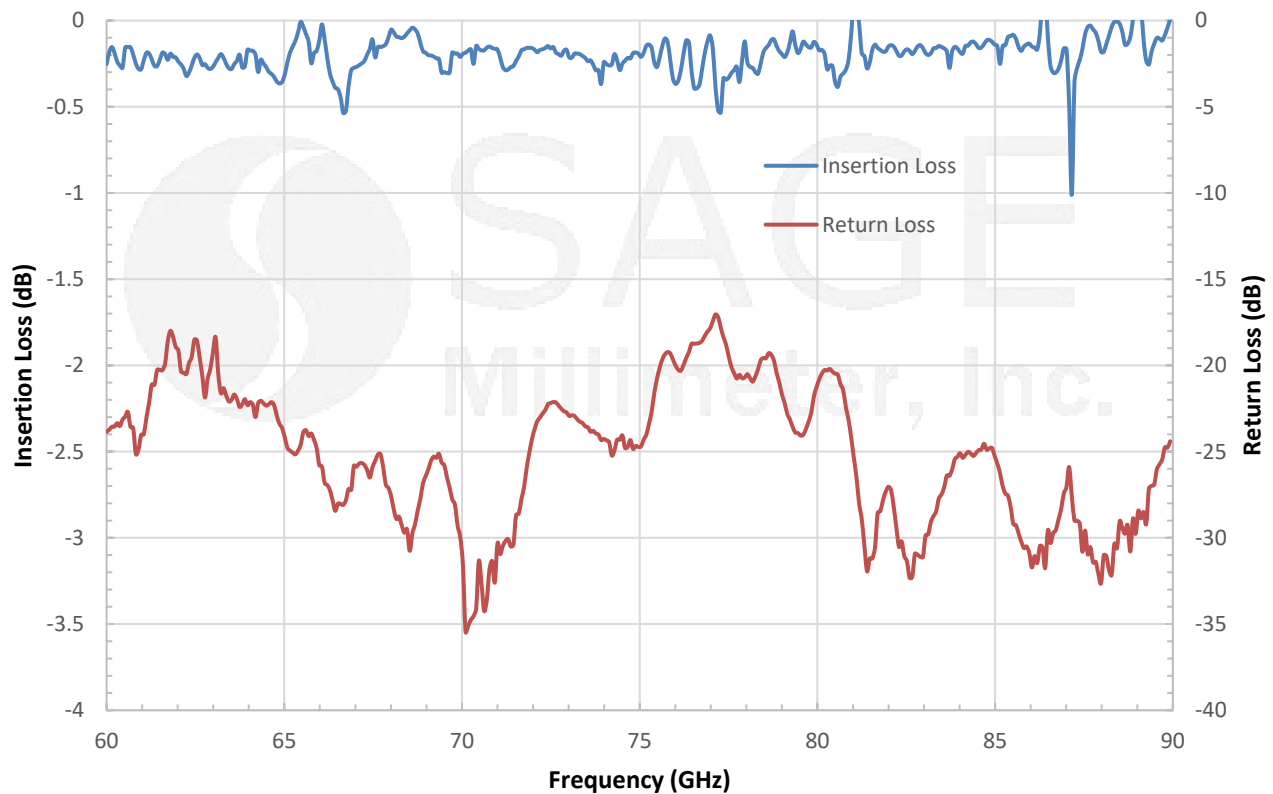

Mechanical Outline: (Unless otherwise specified, all dimensions are in inches [millimeters])

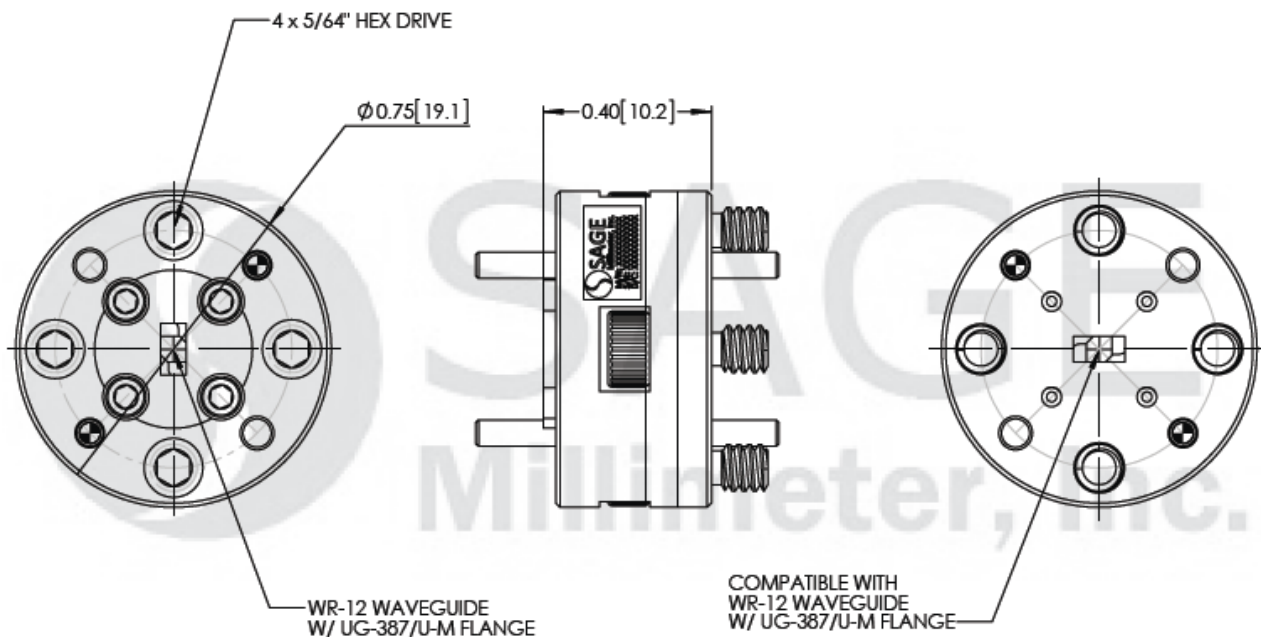

WR-12 Compact Waveguide Twist, 90°, 0.40"

HOW TO USE THE COMPACT TWIST

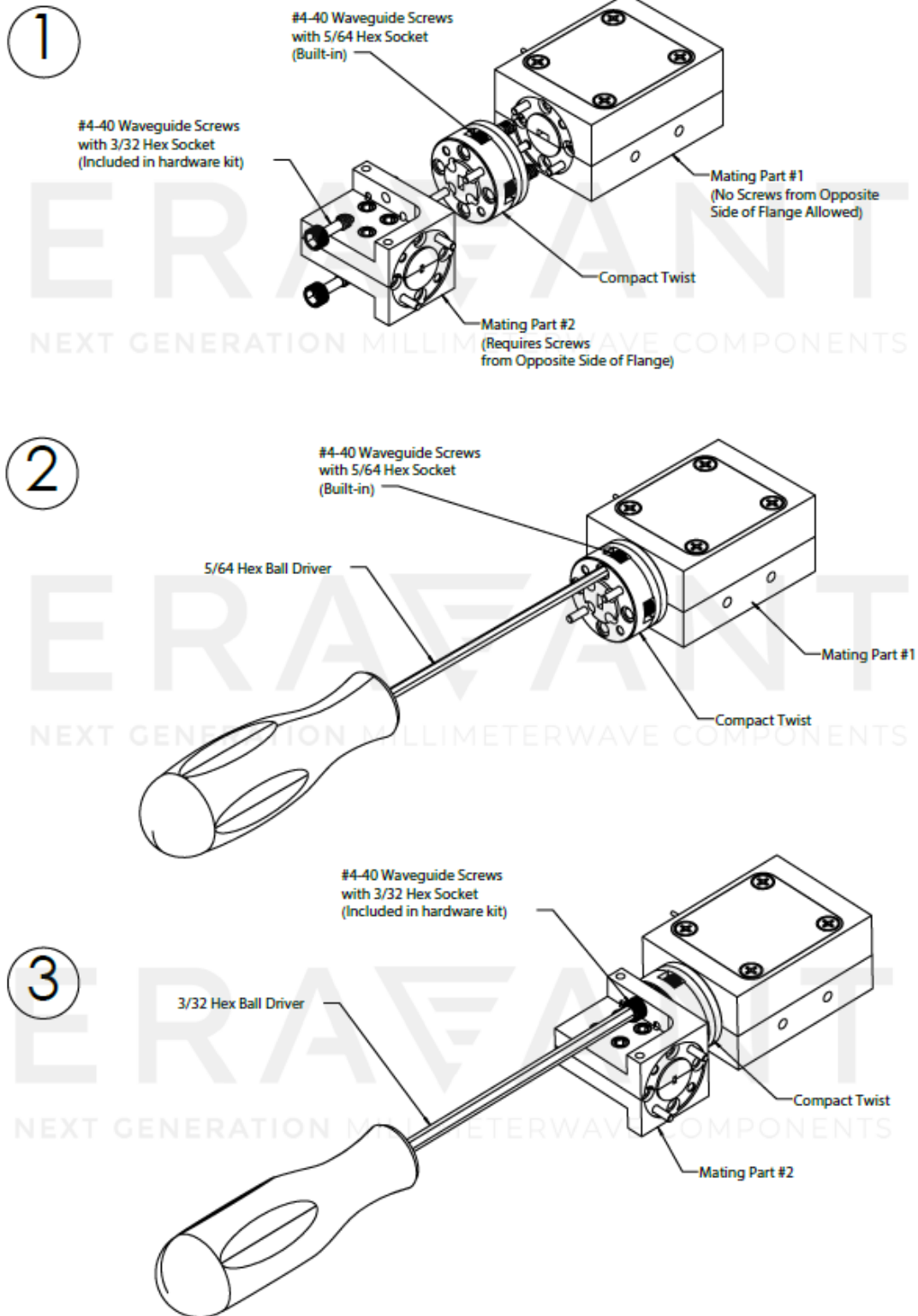

WR-12 Compact Waveguide Twist, 90°, 0.40"

Note:

- A 5/64 hex screwdriver is required to access the built-in 5/64 hex socket waveguide screws.
- For more information on how to access the 5/64 hex socket waveguide screws, please see this blog: <https://www.eravant.com/where-is-the-5-64-waveguide-screw-supposed-to-be-used>
- All data presented is collected from a sample lot. Actual data may vary unit to unit, slightly.
- All testing was performed under +25 °C case temperature.
- Eravant reserves the right to change the information presented without notice.

Caution:

- Any foreign objects in the waveguide will cause performance degradation and possible device damage.

