

## SCT-KFKF-UB-PM4

## 2.92 mm (F) to 2.92 mm (F) Coaxial Adapter, 4 Hole Panel Mount

**SCT-KFKF-UB-PM4** is a 2.92 mm (K) female to 2.92 mm (K) female coaxial adapter with a 4 hole panel mount that covers the frequency range of DC to 40 GHz. This coaxial adapter offers efficient transitioning between the coaxial connectors with a high return loss and typical insertion loss of 0.4 dB. The impedance of the adapter is 50 Ohms. Other configurations are available under different model numbers.



## Electrical Specifications:

Parameter	Minimum	Typical	Maximum
Frequency Range	DC		40 GHz
Insertion Loss		0.4 dB	
Return Loss		25 dB	
Impedance		50 $\Omega$	
Specification Temperature		+25 °C	
Operating Temperature	-40 °C		+85 °C

## Mechanical Specifications:

Item	Specification
Connector 1 Type	2.92 mm (K) Female
Connector 2 Type	2.92 mm (K) Female
Body Material	Stainless Steel
Body Finish	Passivated
Contact Material	Beryllium Copper
Insulator Material	PEI
Adaptor Body Style	4 Hole Panel Mount
Weight	0.2 Oz
Length	0.77"
Outline	CT-KFKF-PM4-LN1

## ECCN

EAR99

## FEATURES

- Instrumentation Grade
- High Return Loss
- Low Insertion Loss

## APPLICATIONS

- Test Lab
- Sub-assemblies

## SUPPLEMENTAL DETAILS



SCT-KFKF-UB-PM4

Typical Performance vs. Frequency

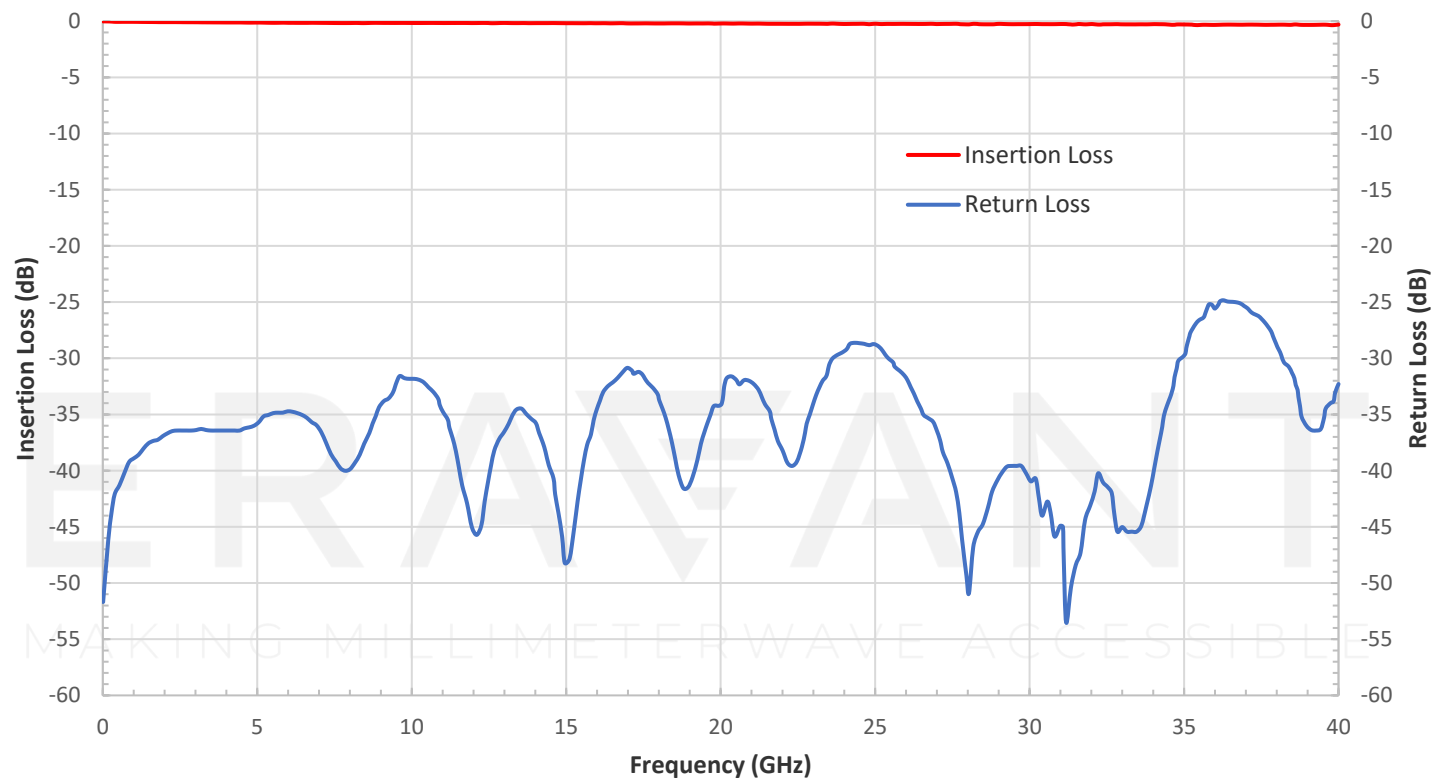

Mechanical Outline: (Unless otherwise specified, all dimensions are in inches [millimeters])

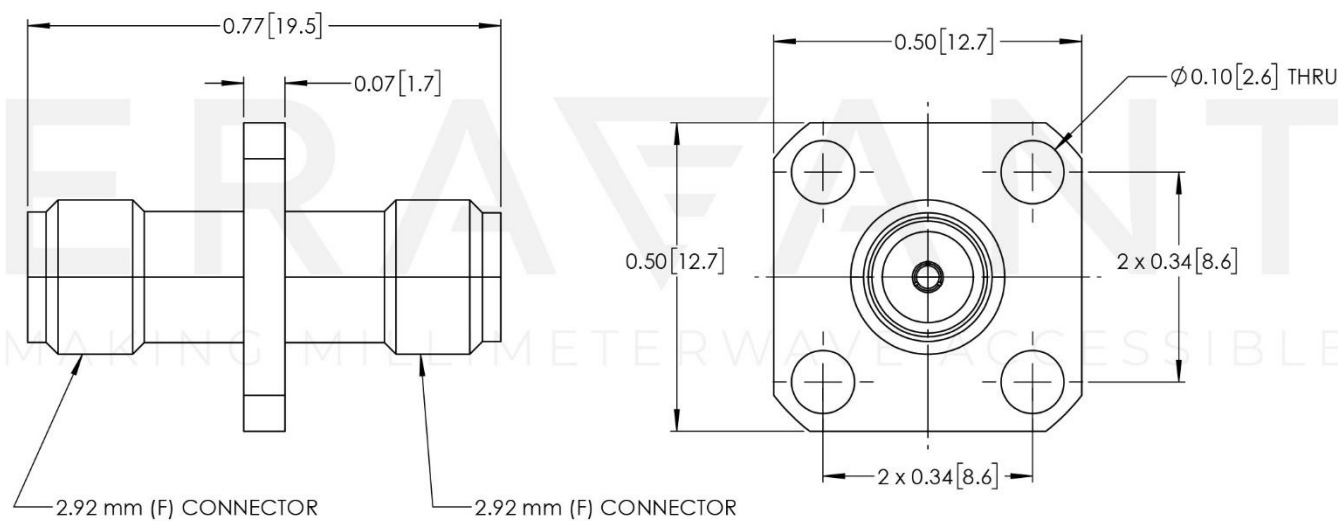

**NOTE:**

- All data presented is collected from a sample lot. Actual data may vary slightly from unit to unit.
- All testing is performed under +25 °C case temperature.
- Eravant reserves the right to change the information presented without notice.

**CAUTION:**

- Exceeding absolute maximum ratings shown will damage the device.
- Proper torque should be applied:  $8.0 \pm 0.15$  inch-pounds ( $0.90 \pm 0.02$  Nm). Torque wrench model SCH-08008-S1 is highly recommended.

ERAVANT

MAKING MILLIMETERWAVE ACCESSIBLE

ERAVANT

MAKING MILLIMETERWAVE ACCESSIBLE