

34 to 37 GHz Power Amplifier, 45 dB Gain, +35 dBm P_{1dB}

Description:

Model SBP-3433734535-KFKF-E3 is a power amplifier with a typical small signal gain of 45 dB and a nominal P_{1dB} of +35 dBm across the frequency range of 34 to 37 GHz. The DC power requirement for the amplifier is +28 V_{DC}/5 A. The RF connectors are female 2.92 mm connectors. Other port configurations, such as male 2.92 mm connectors for either the input or output port, are also available under different model numbers.



Features:

- Broadband Performance
- High Gain
- High Output Power

Applications:

- Radar Systems
- Communication Systems
- Test Equipment

Electrical Specifications:

Parameter	Minimum	Typical	Maximum
Frequency	34 GHz		37 GHz
Gain		45 dB	
P _{1dB}		+35 dBm	
P _{sat}		+37 dBm	
Damage P _{in}			0 dBm
Input Return Loss		9 dB	
Output Return Loss		9 dB	
DC Voltage		+28 V _{DC}	+30 V _{DC}
DC Supply Current		5 A	
Specification Temperature		+25 °C	
Operating Temperature	0 °C		+50 °C

Mechanical Specifications:

Item	Connector
Input	2.92 mm (F)
Output	2.92 mm (F)
Bias	Solder Pin
Case Material	Aluminum
Finish	Gold Plated
Size	3.15" (W) X 3.15" (L) X 3.44" (H)
Outline	BP-ZC-15-H



34 to 37 GHz Power Amplifier, 45 dB Gain, +35 dBm P_{1dB}

Mechanical Outline: (Unless otherwise specified, all dimensions are in inches [millimeters])

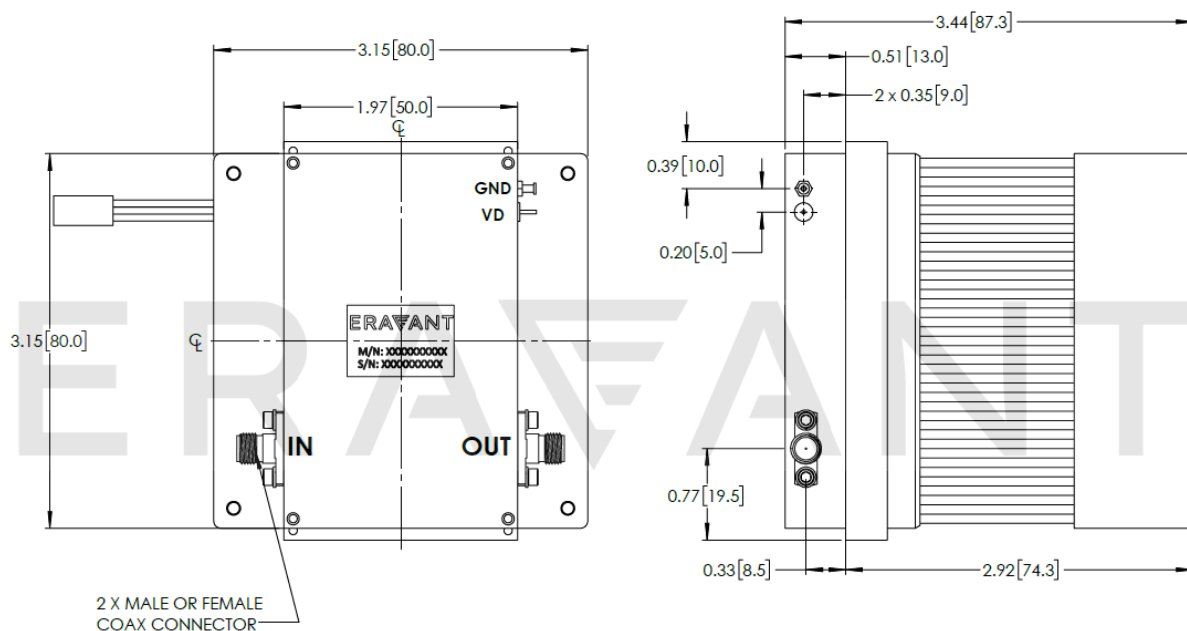

Note:

- Eravant reserves the right to change the information presented without notice.
- Other mechanical configurations are available under different model numbers.

Caution:

- Exceeding absolute maximum ratings shown will damage the device.
- The device is static sensitive. Always follow ESD rules when working with the device.
- The case temperature of the device shall never exceed +50 °C.
- Proper torque, 8.0 ± 0.15 inch-pounds (0.90 ± 0.02 Nm), should be applied. **Eravant torque wrench, model SCH-08008-S1, is highly recommended.**

